

Please, read this manual
carefully before use!

Owner's Manual



Kinetic log splitter 15 ton

KS 15TKG 52/35

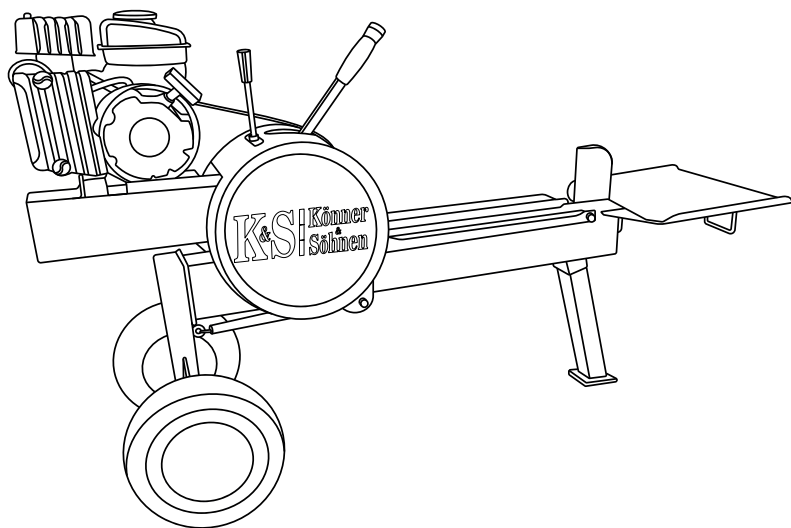



Thank you for your purchase of **Könner & Söhnen** products. This manual contains a brief description of safety, use and debugging. More information can be found on the official manufacturer's website in the support section: ks-power.de/betriebsanleitungen.

You can also go to the support section and download the full version of the manual by scanning the QR code, or on the website of the official importer of Könner & Söhnen products: www.ks-power.de/en.



We care about the environment, therefore, we consider it expedient to save paper and leave in print a short description of the most important sections.



Be sure to read the full version of the manual before getting started!



The manufacturer reserves the right to make changes to the generators, which may not be reflected in this manual. Pictures and photos of the product may vary from its actual appearance. At the end of this manual, you will find contact information which you are free to use in case of any issues.

All data specified in this owner's manual are the most up to date at the time of its publication. The current list of service centers can be found on the website of the official importer: www.ks-power.de/en.



ATTENTION – DANGER!



Failure to follow the instructions marked with this sign may lead to serious injury or death of the operator or third parties.



IMPORTANT!



Useful information on operation of the machine.

Safety symbols and description of inscriptions can be found in the full web version.

SAFETY INFORMATION

1



WARNING!



Please, read this manual carefully before use!

PROTECTING YOURSELF AND THOSE AROUND YOU

1.1



WARNING!



This is a high-powered machine, with moving parts operating with high energy. You must operate the machine safely. Unsafe operation can create a number of hazards for you, as well as anyone else in the nearby area.

Always take the following precautions when using this machine:

- Keep in mind that the operator or user is responsible for accidents or hazards occurring to other people, their property and themselves.
- Always wear protective goggles or safety glasses with side shields while using the log splitter to protect your eyes from possible thrown debris.
- Avoid wearing loose clothing or jewelry, which can get caught in moving parts.
- We recommend wearing gloves while using the log splitter.
- Wear shoes with non-slip soles when using your log splitter. Do not use the machine while barefoot or wearing open toed sandals.
- Wear long pants while operating the log splitter.

- Keep bystanders at least 50 feet away from your work area at all times. Stop the engine when another person or pet approaches.
- Never allow children to operate the log splitter.

SAFETY WITH GASOLINE - POWERED MACHINES

1.2



WARNING!



Gasoline is a highly flammable liquid. Gasoline also gives off flammable vapor that can be easily ignited and cause a fire or explosion.

Always follow these precautions:

- Never run the engine in an enclosed area or without proper ventilation as engine exhaust contains carbon monoxide, which is an odorless, tasteless, and a deadly poisonous gas.
- Replace rubber fuel lines and grommets when worn or damaged and after 5 years of use.
- Fill the fuel tank outdoors with the engine off and allow the engine to cool completely.
- Allow the engine to cool completely before storing in any enclosure. Never store a machine with gasoline in the tank or a fuel container.
- Never make adjustments or repairs with the engine running. Shut down the engine, disconnect the spark plug wire while keeping it away from the spark plug to prevent accidental starting, and then wait 5 minutes before making adjustments or repairs.
- Never tamper with the engine governor setting.
- Never cover the machine while the muffler is still hot.
- Do not operate the engine with the air filter or the carburetor air intake cover removed. Removal of such parts could create a fire hazard. Do not use flammable solutions to clean the air filter.
- The muffler and engine become very hot and can cause severe burns; do not touch them.

SPECIFICATIONS

2

Model	KS 15TKG 52/35
Engine power	6.5 HP
Splitting force	15 ton
Engine type	gasoline
Engine model	KS 230
Max. splitting length	520 mm
Max. splitting diameter	350 mm
Cycle time	~ 2 sec.
Operating position	horizontal
Flywheel speed	450 U/min
Fuel tank volume	3,6 l
Crank case volume	0,6 l
Wheels	12"
Gross dimensions (L*W*H)	1400x380x610 mm
Gross weight	110 kg
Protection class	IP54M



IMPORTANT!



The diameter listed is indicative of the maximum suggested size. A small log can be difficult to split when it contains knots or a particularly tough fiber.

CHECKING THE FUEL LEVEL

1. Unscrew the fuel cap and check the fuel level in the tank.
2. Fill the fuel tank to the fuel filter level.
3. Tighten the fuel cap securely.

Recommended fuel: only unleaded gasoline.

Fuel tank volume: see specifications table.



IMPORTANT!



Wipe up spilled fuel immediately with a clean, dry, soft cloth, as the fuel may harm painted surfaces or plastic parts.



IMPORTANT!



Use only unleaded gasoline. Using leaded gasoline can cause serious damage to the inside of the engine.

CHECKING THE OIL LEVEL

The log splitter is transported free of motor oil. Do not start the engine until it is filled with sufficient amount of motor oil.

1. Unscrew the oil dipstick and wipe it out with a clean cloth.
2. Insert the dipstick without screwing it in.
3. Check the oil level by a mark on the oil dipstick.
4. Add oil if its level is below the mark on the oil dipstick.
5. Screw on the dipstick.

Recommended motor oil: SAE 10W30, SAE 10W40.

Recommended motor oil grade: API Service SG type or higher.

Motor oil quantity: see specifications table.

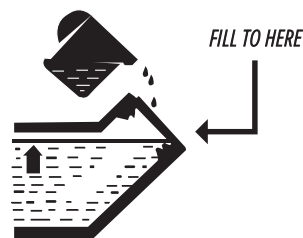

COMMISSIONING

1. Fill the crankcase with engine oil. The recommended amount of oil for each model is indicated in the specification chart.
2. Check oil level with an oil dipstick. It should be between the MIN and MAX marks on the oil dipstick.
3. Check fuel level.
4. Check the air filter for correct installation

In the first 20 operating hours, the following requirements should be met:

1. After the first 20 operating hours, be sure to change the oil. It is better to drain oil while the engine is still hot after operation to ensure quick and complete oil draining.
2. Check and clean the air filter and spark plug.

STARTING THE ENGINE

Before starting the engine, make sure the switch is in the "I" (ON) position (see the pictures below). Turn the rotary engine speed dial to MAX. Set the engine switch to the "CHOKE" position. Grasp the starter handle and slowly pull it until resistance is felt, then pull it with a rapid movement all the way. Repeat the operation until the engine starts. After starting the engine, allow the rope to retract without throwing the starter handle. Put the flaps in the "RUN" position.

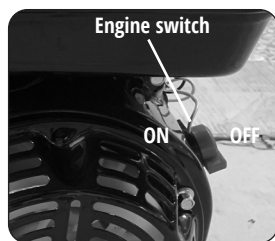
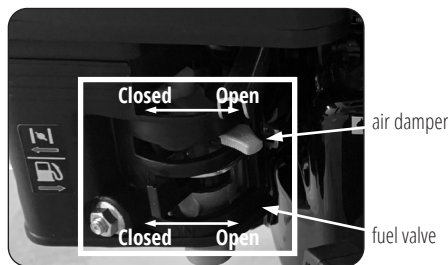

WARNING!



• Do not reach or step across the beam while the log splitter is running. This is a very **UNSAFE** method which could cause personal injury or even death.



CAUTION!



• Never attempt to split wood across the grain. The log splitter was not designed for cross-grain splitting. Doing so could damage the log splitter and may cause personal injury.

• Make sure both ends of the log you are splitting are cut as square as possible. This will prevent the log from sliding out of position while under pressure.



NOTICE



The kinetic log splitter operates differently than a hydraulic splitter. Not operating the machine properly will result in damage to the machine.

Always follow these notices:

- Do not be timid. A rapid movement of the engagement handle is necessary for the rack and pinion to engage and disengage fully without damage.
- The engagement handle should never be stopped in any location between the fully forward or fully backward positions.
- Do not hold the handle in the forward position when the ram stops moving forward. Always pull the engagement handle **RAPIDLY** to the back (auto-retract) position as soon as the log is split or when the ram is at the end of the stroke or when the ram stops moving forward due to a tough log.

1. Place the log on the log splitter. Grasp the log on the sides near the middle of the block. Center the log, side-to-side, on the rail of the log splitter, making sure that one end is against the splitting wedge.



CAUTION!



The engagement handle must be held fully in the split position against the hard stop when splitting. Failure to do so may result in kickback of the handle.

2. With one hand, actuate and hold the safety lever towards you, then **RAPIDLY** actuate the engagement handle fully towards the engine until it contacts the hard stop and hold firmly until the log is split.
3. **IMMEDIATELY AFTER** the log is split, actuate and hold the engagement handle in the auto-retract position to allow the ram to return. If the ram stops before the end of the stroke while splitting a tough log, quickly actuate the engagement handle back to the auto-retract position. Let the ram return and allow the flywheels to gain momentum for another full power split.

STOPPING THE ENGINE

To stop the engine, turn the switch to the "OFF" position. Turn the fuel valve to the "CLOSED" position.

REGULAR MAINTENANCE CHECKLIST

4

Comply with the instructions in this manual! You can find an updated list of service centers on the website of exclusive importer: www.ks-power.de/en

PROCEDURE		Every start or 20 hours	Before each use	Every 5 hours	Each 3 months or after 50 working hrs	Each 6 months or after 100 working hrs
Motor oil	Check		✓			
	Replace	First time 5 hours			✓	
Air filter	Check		✓			
	Clean out	✓				
	Replace				✓	
Check general equipment	Check		✓			
Grease surface of slide rail	Lubricate		✓			
Check belts	Check		✓			
Grease rack and pinion	Lubricate		✓			
Clean engine exterior and cooling	Clean out			✓		
Spark plug	Gap check and control				✓	
	Replace					✓

MAINTENANCE OF AIR FILTER

A dirty air filter restricts air flow into the carburetor, decreases engine performance and reduces log splitter performance. Check the air filter and clean it before every start. If the air filter is damaged, replace it. When working in extremely dirty conditions, clean the filter every 10 hours, otherwise replace it every 25 hours if needed.

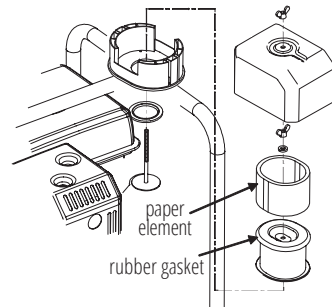

IMPORTANT!



Never operate the engine without air filter. The air filter prevents high-speed wear of the motor pump engine.

SPARK PLUG MAINTENANCE

5

Spark plug must be intact, free of soot deposits and must have a correct gap.

SPARK PLUG CHECK:

1. Remove the cap from the spark plug.
2. Remove the spark plug by means of a corresponding spanner.
3. Examine the spark plug. If it is shattered, it is necessary to replace it. Recommended replacement spark plugs – F7TC.
4. Measure the gap. It must be within a range of 0.7 – 0.8 mm.
5. In case of repeated use, the spark plug must be cleaned with a metal brush. After that set the correct gap.
6. Put the spark plug back in its place by means of a spark plug spanner.
7. Replace the spark plug cap.



WARNING!



All bearings of your splitter are sealed units and should be sufficiently lubricated to last the life of your machine with normal use.

The rack and pinion should be completely greased before every use. Before performing any maintenance procedure or inspection, stop the engine, wait five minutes to allow all parts to cool. Disconnect the spark plug wire, keeping it away from the spark plug.

COMPONENTS IN THE PACKAGE

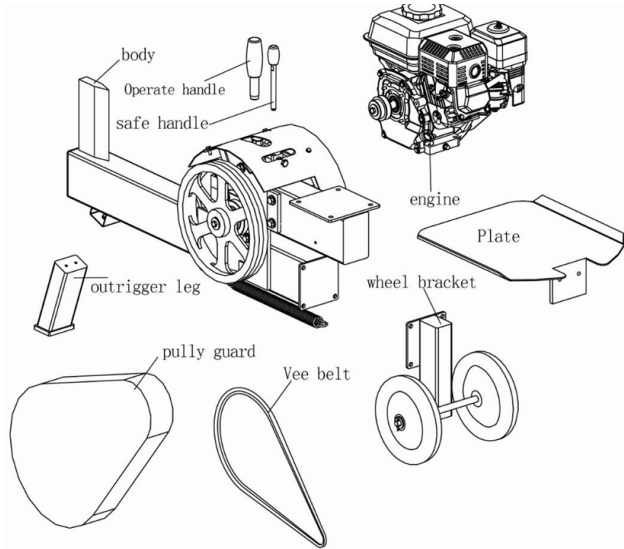

ASSEMBLY

STEP 1

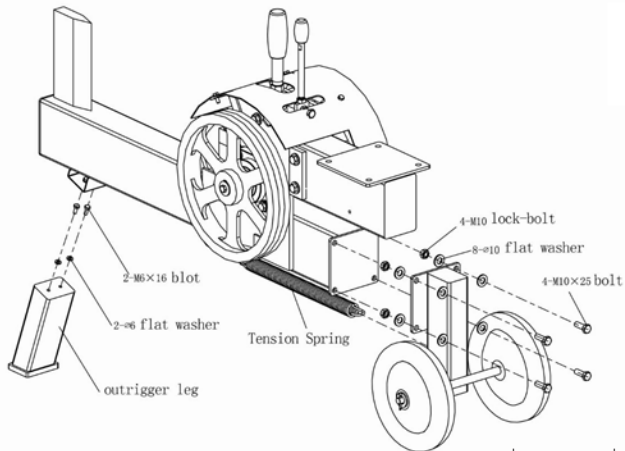

STEP 2

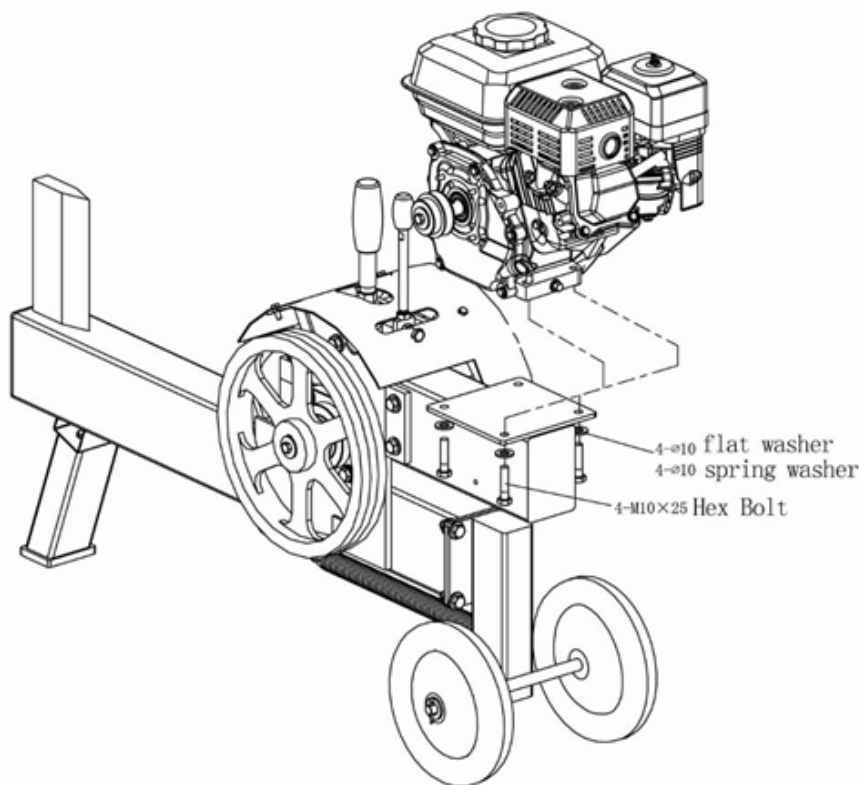

STEP 3

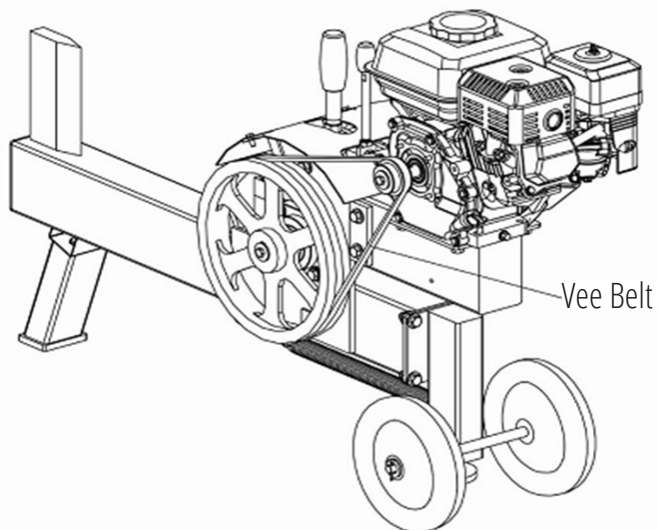

STEP 4

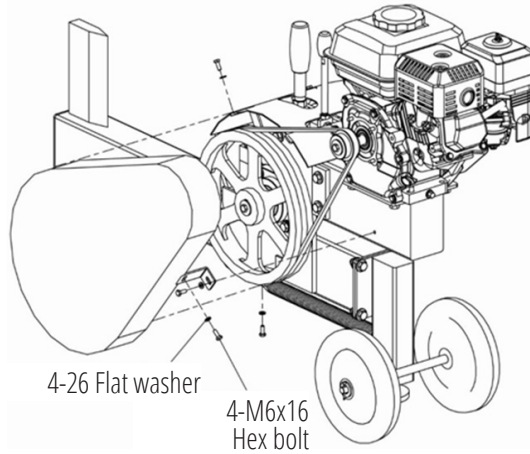

STEP 5

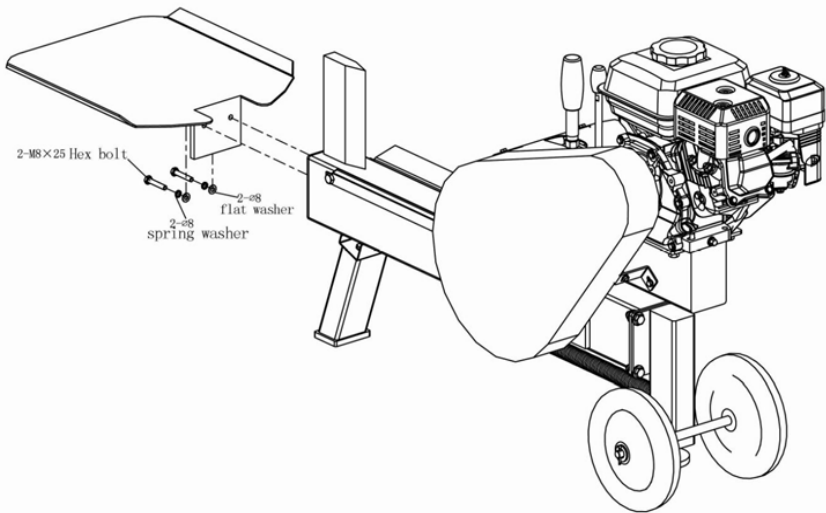

WARRANTY SERVICE TERMS

9

The international manufacturer warranty is 1 year. The warranty period starts from the date of purchase. In cases where a warranty period is longer than 1 year according to local legislation, please contact your local dealer. The Seller of the product is responsible for granting the warranty. Please contact the Seller for warranty. If the product fails within the warranty period because of defects in workmanship, it will be exchanged for the same product or repaired.

The warranty card should be kept throughout the warranty period. In case of warranty card loss, a second one will not be provided. The Customer must provide the warranty card and proof of purchase when requesting any repair or exchange. Otherwise, the warranty service will not be provided. The warranty card attached to the product during sale should be correctly and fully completed by the retailer and customer, signed and stamped. In other cases, the warranty shall be deemed invalid.

Provide clean product to the service center. Parts that must be replaced are the property of the service center.



EC Declaration of Conformity

Nr. 088

The following products have been tested by us with the listed standards and found in compliance with the European Community Machinery Directive 2006/42/EC, Electromagnetic compatibility Directive (EMC) 2014/30/EC, Noise Directive 2000/14/EC.

Manufacturer: DIMAX INTERNATIONAL GmbH
Address: Hauptstr. 134, 51143 Cologne, Germany

Product: Gasoline log splitter "Könner & Söhnen"

Type / Model: KS 15TKG 52/35, KS 27THG 65/55

The statement is based on a single evaluation of above mentioned products. It does not imply an assessment of the whole production and does not permit the use of the test lab. logo. The manufacturer should ensure that all product in series production are in conformity with the product sample detailed in this report. The applicant should hold the whole technical report at disposal of the competent all the right.

Applied EC Directives: 2006/42/EC Machinery Directive
2000/14/EC Noise Directive (amended by 2005/88/EC)
2014/30/EC Electromagnetic compatibility Directive
(EU) 2016/1628 Non-Road mobile machinery emissions
2000/14/EC Noise Directive

Applied Standards: EN ISO 12100:2010
EN 609-1;2017
EN 55014-1:2017
EN 55014-2:1997/A2:2008
EN 61000-3-2:2014
EN 61000-3-3:2013

Gasoline engine KS 230 corresponds to European Emission Standard Euro V.
This is confirmed by EU TYPE-APPROVAL CERTIFICATE granted by NSAI certification.
Technical service responsible for carrying out the test -TÜV SÜD Auto servise GmbH in München, Germany
Date of issue 17/01/2019

2000/14/EC_2005/88/EC Annex VI

For model KS 15TKG 52/35, KS 27THG 65/55 noise guaranteed $L_{wa} = 99$ dB (A).



19

Issued Date: 2020-10-06
Place of issue: Warsaw city
Technical expert: Homenco A.

DIMAX International GmbH
Steuer-Nr.: 103 5722 2493
USt-Id-Nr.: DE296177274
H. Hilg

We DIMAX INTERNATIONAL GmbH hereby declare that specified above conforms covering European Parliament and Council Directives, 2006/42/EC of 17 May 2006 Machinery Directive, Electromagnetic compatibility Directive (EMC) 2014/30/EC of 26 February 2014, Noise Directive 2000/14/EC of 8 May 2000. The CE mark above can be used under the responsibility of manufacturer. After completion of an EC declaration of Conformity and compliance with all relevant EC directives.

CONTACTS

Deutschland:

DIMAX International GmbH
Deutschland, Hauptstr. 134,
51143 Köln,

www.ks-power.de

Ihre Bestellungen

orders@dimaxgroup.de

Kundendienst, technische Fragen und Unterstützung

support@dimaxgroup.de

Garantie, Reparatur und Service

service@dimaxgroup.de

Sonstiges

info@dimaxgroup.de

Polska:

DIMAX International
Poland Sp.z o.o.

Polen, Warczawska, 306B
05-082 Stare Babice,

www.ks-power.pl
info.pl@dimaxgroup.de

Україна:

ТОВ «Техно Трейд КС», вул.
Електротехнічна 47, 02222,
м. Київ, Україна

www.ks-power.com.ua
sales@ks-power.com.ua

Россия:

ТД «Рус Энержи К&С» 129090,
г.Москва, проспект Мира,
д.19, стр.1, эт.1, пом.1,
комн.66, офис 99В

www.ks-power.ru
info@ks-power.ru